



Sofia Important Interface for Rail Freight Transport in the Balkans

MULTIMODAL LOGISTICS PLATFORM **SOFIA- WEST**

PROJECT CEF ACTION NO 2017-BG-TM-0029-W



Co-financed by the Connecting Europe
Facility of the European Union

05.04.2019

Location links Sofia

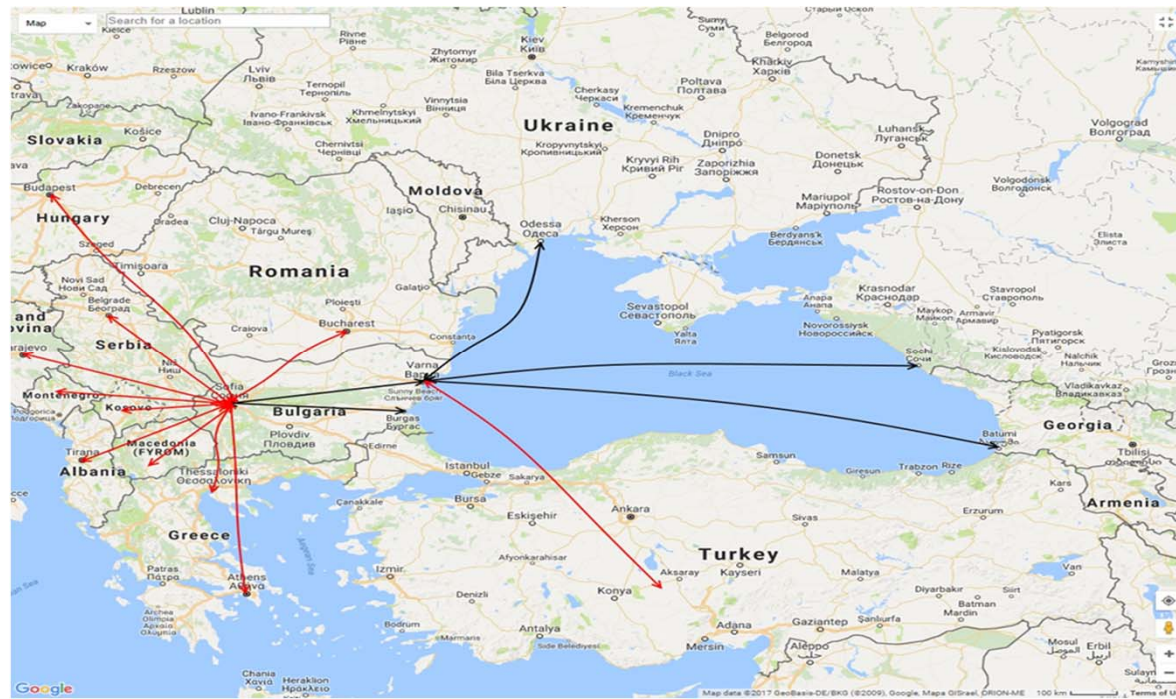

Rail – Road freight operations Sofia

- ❑ TransExpress Ltd. is operating Rail-Road terminal next to Voluyak railway station, part of **Sofia railway node**, Sofia – West side (Bulgaria);
- ❑ The terminal currently serves single wagonload or group of wagons, for further “**last mile**” delivery;
- ❑ The project **Multimodal Logistic Platform Sofia- West** plans further enlarging the existing terminal to serve **740 m long trains**, conventional and intermodal freight;
- ❑ The terminal extension shall cover **80 hectares** of land, owned by TransLog Cargo Ltd.;



Location MLP Sofia-West

Links to:

- **Western and Central Europe** by rail
- **Western Balkans** by rail /road
- Terminals and Hubs in **neighboring countries** –Greece, Romania, Turkey
- Sea ports at **Black sea, Greek** and Turkish ports
- **Multimodal** access to **China, Central Asia, Caucasus countries,** Iran, Ukraine and Russia



Transport network system

Direct access to **national road and rail networks, international road E79/E80**; Located along the Core TEN-T Network **OEM and Rail freight corridor 7**



Business provisions

- ❑ Lack of rail-road and intermodal terminal in Bulgaria able to handle **740 m long trains** both **intermodal and conventional** traffic
- ❑ Prospective **market segments** to be served:
 - **Wagonload** traffic from/to Sofia region
 - Hinterland port for **intermodal traffic** from seaports of Varna/ Burgas/ **Thessaloniki/ Piraeus/** Istanbul other European sea ports at North Sea and Adriatic Sea
 - Intermodal traffic from/to the continent of Europe
 - Land bridge to **China**



Structure of the MLP Sofia - West

Rail road terminal – to serve wagon-truck operations

Intermodal operations – to serve ITUs

Logistics center – warehouses for storage, assortment and other types of handling goods; last mile distribution

Railway station – 5 new railroads for receiving and forwarding railroad and intermodal trains

Depot of empty containers – for storage of empty containers

Provides full neutrality - all transport operators will benefit open access and non-discriminatory treatment



General layout MLP Sofia-West

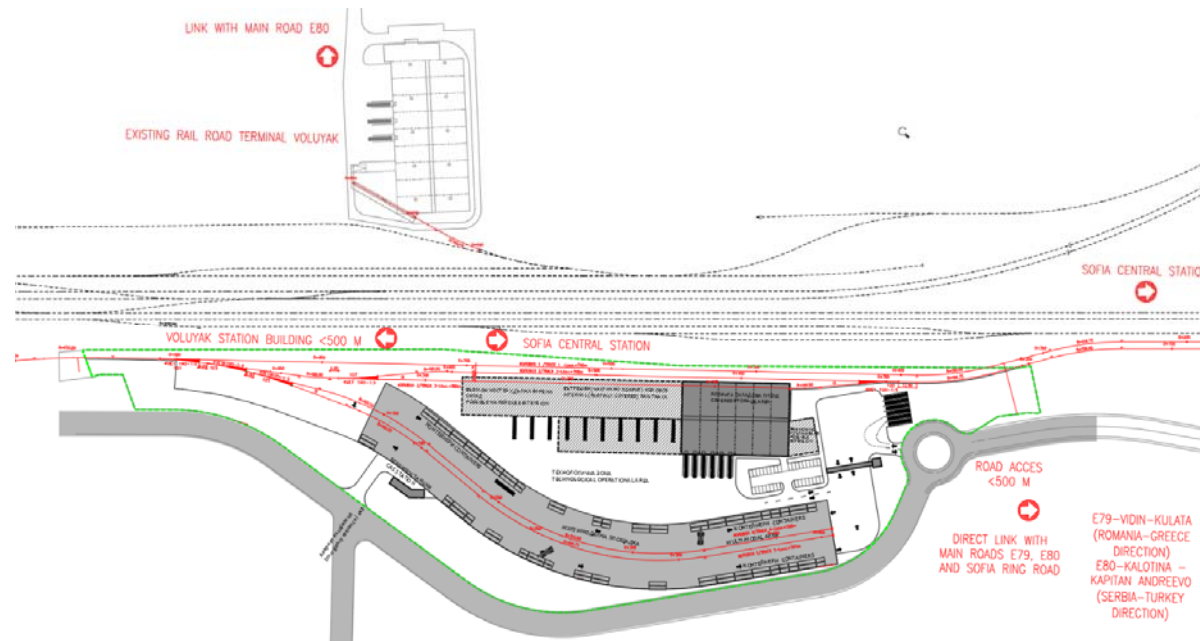

Stakeholders

- ❑ **Project Promoters:** TransLog Cargo, TransExpress
 - independent private legal entities; own land; freight forwarding and logistics services operator; terminal operations and multimodality
- ❑ **Partner: SE NRIC**
 - public entity, the national railway IM; access to national railway system
- ❑ **Advisory Board:** UIRR, IBS, Green Transport Cluster, NSBS to guarantee neutrality, non-discriminatory treatment
- ❑ Supported by the MTITC of Bulgaria



Terminal characteristics

Phase I	Total MLP area	70 hectares
	Rail siding tracks	5
	Total length of rail tracks	3100m
	Total multimodal, operational and storage area	46 500 sq.m.
Phase II	Warehouse area	3800 sq.m.
	Total multimodal, operational and storage area	60 000 sq.m.
Phase III	Total MLP area	100 hectares
	Warehouse area	10 000 sq.m.
	Total multimodal, operational and storage area	80 000 sq.m.



Implementation plan

- ❑ Preparation Project phase I completed:
 - **Environmental** screening decision obtained (no need of EIA)
 - **Zoning procedures** for the land plots completed
 - Preliminary design developed
 - Partnership agreement with National Railways
- ❑ **EU Grant** for development of the project Phase I – signed Grant agreement under CEF Blending Transport 2017



Implementation plan

Phase I

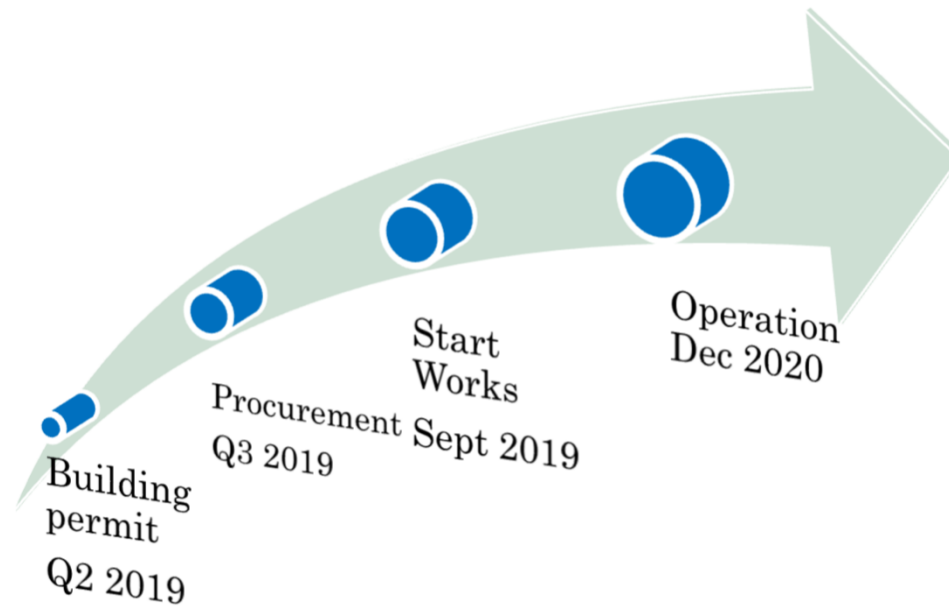

Contact

Dr. Ivan Petrov
TransLog Cargo Ltd.
TransExpress Ltd.
petrov@transexpress.bg



Co-financed by the Connecting Europe
Facility of the European Union